

# 12 MONTHS / 3,600 LITRES FILTER REPLACEMENT

For optimum performance, it is recommended to replace the filter once every 12 months / 3,600\* litres of water from initial usage.

\*Based on average ten (10) litres a day usage.

• It is strongly recommended to replace the filter according to its recommended usage for hygiene purposes & optimum performance.

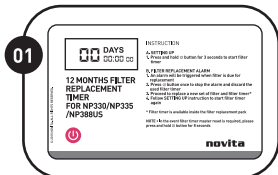

## STEP 01

An alarm will be triggered from the filter replacement timer when filters are due for replacement after twelve (12) months of usage. Press **⏻** button on the filter replacement timer once to stop the alarm.

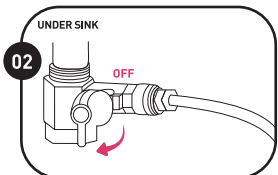

## STEP 02

Proceed to switch OFF the main water supply.

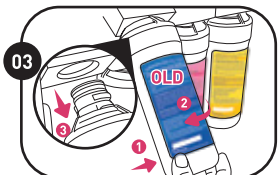

## STEP 03

Grab the individual filter cartridge and twist it in an anticlockwise direction to remove it one by one, starting from HydroPlus® or HydroPure™ Filter. Drain and dispose the exhausted filter.

• Fine particle of carbon dust may remain at the interior of the filter head cavity and this is normal.

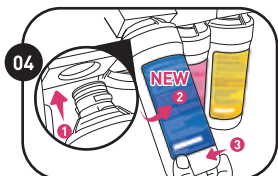

## STEP 04

Insert the new individual filter cartridge into its respective filter head cavity and twist them in clockwise direction to tighten it snugly.

- Ensure both coloured labels on the filter cartridge and filter head connectors are matched.
- Ensure the individual filter cartridge is properly assembled and installed in position before usage.
- Microfiber cloth is available inside the filter replacement pack to dry any water spillage during filter replacement.

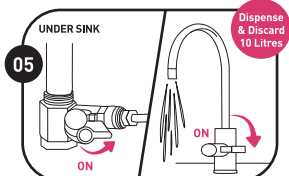

## STEP 05

Switch ON main water supply and it is recommended to control the water inflow rate to be at about 2.5 Litres/min. For optimum water purification results, it is recommended to rinse through the brand-new filters before usage. Turn ON the drinking faucet to dispense and discard first ten (10) litres of water and check and feel for any visible leakage.

• For initial usage, fine particle of carbon dust may remain in water. This is normal and harmless.

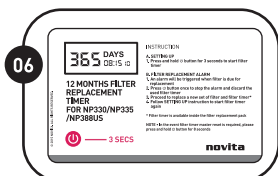

## STEP 06

Press and hold **⏻** button on the filter replacement timer for three (3) seconds to start filter timer. Proceed to paste the filter replacement timer at a visible and accessible area. The under sink drinking water filtration system is now ready for usage.

- An alarm will be trigger when filter is due for replacement.
- In the event filter replacement timer master reset is required, please press and hold **⏻** button for eight (8) seconds.

• All Information is accurate at the point of print. novita reserves all rights to update the information without prior notice.